

FLAMERITE FIRES
2020-21

Reasons why Flamerite are the UK's leading specialist electric fire manufacturer:



Unprecedented Customer Service

Friendly assistance from real people – we're extremely easy to contact by phone or email.



Ultra-reliability

All our award-winning electric fires and fireplaces are designed, assembled and patented, made in Great Britain to the highest UK and European Standards (BS-EN).



2-year warranty as standard

Every Flamerite fire comes as standard with a 2-year warranty, extendable to 3 years with access to certain benefits guaranteeing the longevity of your fireplace for years to come.



Shop or Home Direct Delivery

Everything we sell across the UK is delivered safely on our own transport; we do not use a courier service.



www.flameritefires.com

FLAMERITE FIRES
2020-21



There are four attractive flame pictures featured in the Flamerite Fires range, which can be enjoyed with or without heat. Each of them are low energy LED as standard. Scan the QR code to view the video on our website.



DESIGNED FOR LIVING

2020 -21

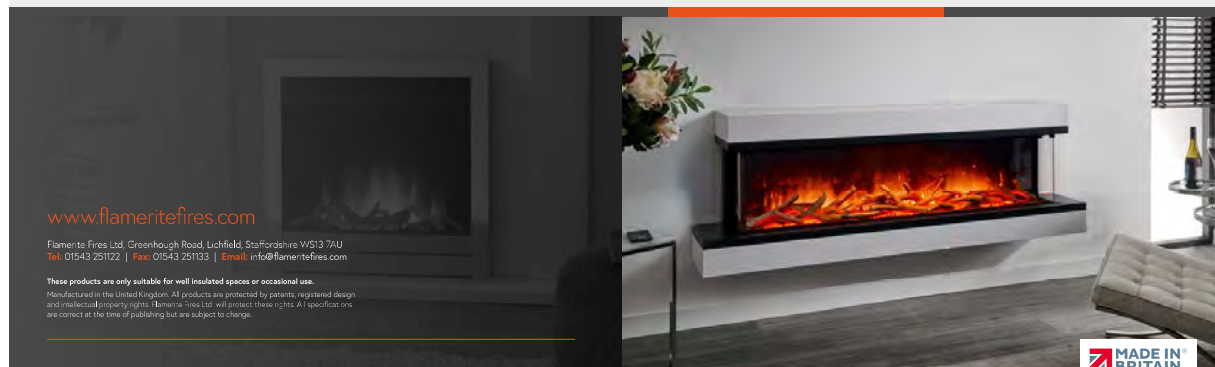

www.flameritefires.com

Flamerite Fires Ltd, Greenhough Road, Lichfield, Staffordshire WS13 7AU
Tel: 01543 251122 | Fax: 01543 251133 | Email: info@flameritefires.com

These products are only suitable for well insulated spaces or occasional use.
Manufactured in the United Kingdom. All products are protected by patents, registered design and intellectual property rights. Flamerite Fires Ltd will protect these rights. All specifications are correct at the time of publishing but are subject to change.



FLAMERITE FIRES
2020-21



OVER 21 YEARS A FAMILY RUN UK MANUFACTURER

Flamerite Fires was founded in 1999 in the historic city of Lichfield, carrying on a thirty-year family tradition of producing electric fires with outstanding design. Since then Flamerite Fires has led the way in changing the look and feel of what was a basic product, falling out of fashion, into a modern and stylish appliance, sought after by homemakers old and young for rooms of all kinds.

Over its 21 year history, Flamerite Fires has won numerous awards and gained a reputation for integrity, excellent customer service and support for the independent retail sector as well as for producing high quality, innovative electric fires, stoves and suites.

Now, with half a century's expertise in manufacturing electric fires and fireplaces, we proudly welcome a third generation into the family business, who remain committed to building good working relationships whilst being mindful of the need to protect the environment and striving for continuous improvement in everything Flamerite does.



Energy efficient LED fires



Smart eControl
Easy to use iOS & Android app with advanced features to control your fire.



A strong and radiant flame image with a deep fuel reflection.



A tilting glass panel that enhances the flame and conceals the heater.



Fire eControl
Easy to use dual controls, a remote or iOS & Android app both control your fire.



A vibrant, colourful flame and fuel effect with a deep high definition reflection.



A log fuel effect featuring a realistic and internal radiant burn at the heart of your fire.

CONTENTS

Glazer modular fires.....	04-30
Wall mounted fires.....	31-38
Wall mounted & floor standing suites.....	39-57
Hearth inset fires & cast.....	58-72
Specifications.....	74-75

Once you've decided on which fire you want...

...choose your control and flame effect from **two** great options



Smart eControl app

Easy to use iOS & Android app with advanced features to control your fire.

- Manual & app control
- Thermostatically controlled heat
- Dimmable LED flame effect with flicker control
- Adaptive 7 day single event programmable timer
- Open window detection



Fire eControl app & remote

Easy to use dual controls, a remote or iOS & Android app both control your fire.

- Manual, remote & app control
- Thermostatically controlled heat
- Dimmable LED flame effect with colour change function
- Adaptive 7 day single event programmable timer
- Open window detection
- 5 pre-set scrolling animations



WITH ADDITIONAL COLOUR CHANGE FUNCTION



GLAZER MODULE

ONE FIRE NUMEROUS OPTIONS

Our stylish Glazer modular range will make a statement in any room. The Glazer is available to purchase on its own as a 3, 2 or 1 sided fire or match it with one of our four suites.

- Panoramic 3, 2 and 1 sided glass burn areas
- Cinderwood log effect
- OmniGlide 2 position front glass
- Thermostatically controlled 750W/1500W concealed fan heater
- Choice of: Smart-eControl featuring Radia Flame 3D or Fire-eControl featuring Nitra Flame
- Inset, a flat wall fix or floor standing



OMNIGLIDE® CinderWOOD

GLAZER 3-2-1 SIDED FIRE

As standard, the Glazer range can easily be converted into a 3, 2 or 1 glass sided fire to suit your décor requirement.

MINIMUM OPENING TO FIT AND INSET THE FIRE

Model	H	W1side	W2side	W3side	D
600	725mm	645mm	625mm	610mm	265mm
900	505mm	945mm	925mm	910mm	265mm
1000	575mm	1045mm	1025mm	1010mm	265mm
1500	575mm	1545mm	1525mm	1510mm	265mm
1800	575mm	1845mm	1825mm	1810mm	265mm

VISIBLE BURN AREA AFTER FITTING

Model	H	W1side	W2side	W3side	D2/3side
600	500mm	645mm	625mm	600mm	180mm
900	280mm	945mm	925mm	900mm	180mm
1000	350mm	1045mm	1025mm	1000mm	180mm
1500	350mm	1545mm	1525mm	1500mm	180mm
1800	350mm	1845mm	1825mm	1800mm	180mm

See website for more dimension details.



3 SIDED FIRE



2 SIDED FIRE

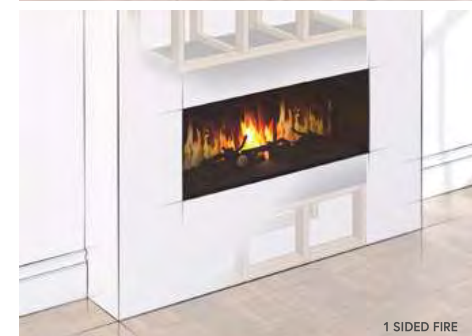

1 SIDED FIRE

GLAZER 1800



The GLAZER 1800 is available as a 3, 2 or 1 sided fire.



3 SIDED FIRE



2 SIDED FIRE



1 SIDED FIRE



3 SIDED FIRE

See page 5 for details.



GLAZER 1000



GLAZER 900



3 SIDED FIRE



2 SIDED FIRE



1 SIDED FIRE

GLAZER 600

Featuring Glazer 600 with our Tropo modular suite – see page 28 for details

3 SIDED FIRE

2 SIDED FIRE

1 SIDED FIRE

MODULAR FIRE

15

MODULAR FIRE

15



EXO 600

EXO 600



EXO 600 CB



EXO 1000 FS

EXO 1000



EXO 1000



EXO 1000 CB



EXO 900L CB



EXO 900S



EXO 900S CB



EXO 900L

EXO 900



EXO 1500





IONA 1000



IONA 600 CB



IONA 1000 CB



EXO 1000 FS

Don't forget to choose your control

- Smart eControl or
- Fire eControl

See pages 2-3

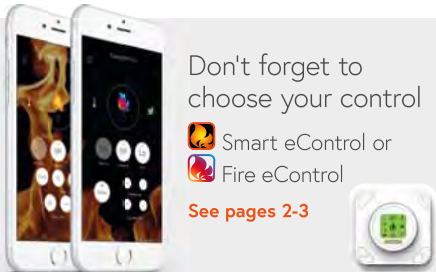

IONA 600



IONA 1500



IONA 900

IONA 900S



IONA 900S CB



IONA 900L



IONA 900L CB



LUCA 450

LUCA 450 free-standing



LUCA 450 wall mounted



LUCA 450 free-standing with log store



LUCA 1500



GLAZER MODULE SPECIFICATIONS

LUCA 450 Base height: 135mm | Base length: 525mm | Depth: 300mm
Top height: 135mm | Top length: 525mm | Reversible log store height: 310mm



Wall mounted



With flue pipe



Free-standing with surround



Free-standing with reversible log store
CLOSED



OPEN



With flue pipe

All Luca models available in black only.

LUCA 1500

Base height: 135mm | Base length: 1600mm | Depth: 300mm
Top height: 135mm | Top length: 1600mm

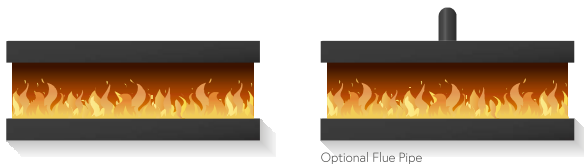

Optional Flue Pipe

All Luca models available in black only.

EXO 1000

Base height: 140mm | Base length: 1500mm | Depth: 320mm
Top height: 140mm | Top length: 1200mm



EXO 1000

EXO 1000 FS

Available in arctic white, pastel grey or ivory cream

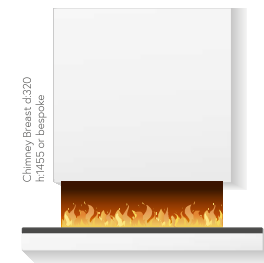

Chimney Breast d.320
h.1455 or bespoke

EXO 1000 CB

EXO 1500 & IONA 1500

Base height: 140mm | Base length: 1800mm | Depth: 320mm
Top height: 140mm | Top length: 1600mm



EXO 1500

IONA 1500

Available in arctic white, pastel grey or ivory cream

EXO 900

Base height: 140mm | Base length: 1500/1200mm | Depth: 320mm
Top height: 140mm | Top length: 1200/1000mm



EXO 900L

EXO 900S

Available in arctic white, pastel grey or ivory cream

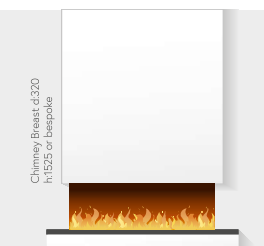

Chimney Breast d.320
h.1525 or bespoke

EXO 900S/L CB

TROPO 1000 & 600

Base height: 400mm | Base length: 1500/820mm | Depth: 320mm
Top height: 140mm | Top length: 1200/700mm



1200TV Link

Compartment size
w:1100 h:180 d:265

TROPO 1000

TROPO 600

Available in arctic white, pastel grey or ivory cream

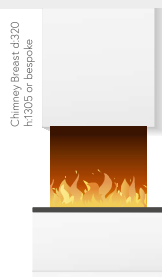

Chimney Breast d.320
h.1305 or bespoke

TROPO 600 CB

STRATO 900

Base height: 400mm | Base length: 1500/1200mm | Depth: 320mm
Top height: 1525mm or bespoke | Top length: 1000mm



STRATO 900 CB

STRATO LINK R

Available in arctic white, pastel grey or ivory cream

LINK DIRECTION

○ LEFT ○ RIGHT



STRATO TV LINK R

IONA 1000

Base height: 140mm | Base length: 1500mm | Depth: 320mm
Top height: 140mm | Top length: 1200mm



IONA 1000

Available in arctic white, pastel grey or ivory cream



IONA 1000 FS



Chimney Breast d:320
h:1455 or bespoke

IONA 1000 CB

IONA 900

Base height: 140mm | Base length: 1500/1200mm | Depth: 320mm
Top height: 140mm | Top length: 1200mm



IONA 900L

Available in arctic white, pastel grey or ivory cream



IONA 900S

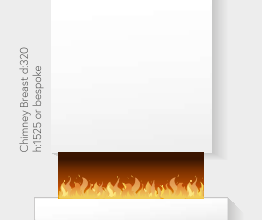

Chimney Breast d:320
h:1525 or bespoke

IONA 900S/L CB

EXO 600 & IONA 600

Base height: 140mm | Base length: 820mm | Depth: 320mm
Top height: 140mm | Top length: 700mm



EXO 600



EXO 600 CB



IONA 600



IONA 600 CB

Available in arctic white, pastel grey or ivory cream

Chimney Breast d:320 | h:1305 or bespoke

WALL MOUNTED FIRES

Whether you prefer the minimal frameless look or something in the way of a decorative surround, our continued wall mounted range benefits from the same state of the art features as the popular Glazer.

One sided only, fully inset or available to easily hang on a flat wall, they also offer hidden heat & a choice of controls as well as a variety of fuel effects including CinderWood or white pebble and glass beads.

GOTHAM 750S & 750T

- Cinderwood log effect
- Choice of Smart eControl featuring Radia Flame 3D or Fire eControl featuring Nitra Flame
- Thermostatically controlled 750W/1500W concealed fan heater
- OmniGlide 2 position front glass with dimmable LED flame effect
- Frameless
- Inset wall mounted
- 750S visible burn area h:405 w:754
- 750T visible burn area h:650 w:754



Gotham 750T

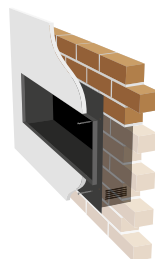

OMNIGLIDE® CinderWOOD



GOTHAM 600

- Cinderwood log effect
- Choice of Smart eControl featuring Radia Flame 3D or Fire eControl featuring Nitra Flame
- Thermostatically controlled 750W/1500W concealed fan heater
- OmniGlide 2 position front glass with dimmable LED flame effect
- Frameless with optional silver or brass trim
- Inset wall mounted
- Visible burn area h:500 w:604

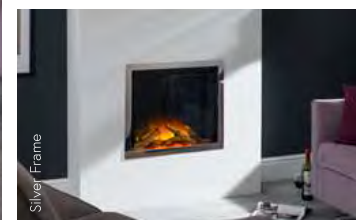

Silver Frame

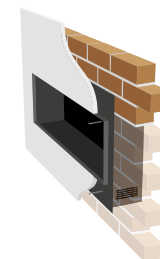

OMNIGLIDE® CinderWOOD





34

GOTHAM 1300

- Cinderwood log effect
- Choice of Smart eControl featuring Radia Flame 3D or Fire eControl featuring Nitra Flame
- Thermostatically controlled 750W/1500W concealed fan heater
- OmniGlide 2 position front glass with dimmable LED flame effect
- Frameless
- Inset wall mounted
- Visible burn area h:280 w:1304



OMNIGLIDE® CINDERWOOD

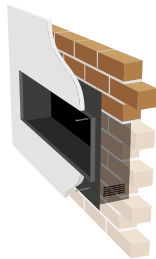

35

GOTHAM 900

- Cinderwood log effect
- Choice of Smart eControl featuring Radia Flame 3D or Fire eControl featuring Nitra Flame
- Thermostatically controlled 750W/1500W concealed fan heater
- OmniGlide 2 position front glass with dimmable LED flame effect
- Frameless with optional silver or brass trim
- Inset wall mounted
- Visible burn area h:280 w:904



OMNIGLIDE® CINDERWOOD



Silver Frame





VERADA

- Log and embers
- Choice of Smart eControl featuring Radia Flame 3D or Fire eControl featuring Nitra Flame
- Thermostatically controlled 1000W/2000W concealed fan heater
- OmniGlide 2 position front glass with dimmable LED flame effect
- Fire fascia options: graphite, black or grey mirror
- Inset or flat wall mounted
- Available in 1000mm or 800mm widths

Verada 800 grey mirror



OMNIGLIDE®



OMNIGLIDE 900

- Cinderwood log effect
- Choice of Smart eControl featuring Radia Flame 3D or Fire eControl featuring Nitra Flame
- Thermostatically controlled 750W/1500W concealed fan heater
- OmniGlide 2 position front glass with dimmable LED flame effect
- Fire fascia options: graphite, black or grey mirror
- Inset or hang on wall mounted

OmniGlide 900 grey mirror



OMNIGLIDE® CinderWOOD





ENNIO 4 SIDE

- Cinderwood log effect
- Choice of Smart eControl featuring Radia Flame 3D or Fire eControl featuring Nitra Flame
- OmniGlide 2 position front glass
- Concealed 750W/1500W thermostatically controlled heater
- Fire trim options: silver, gun metal or brass
- Inset wall mounted with 3 side hearth inset fire also available p.59

Silver Frame



OMNIGLIDE® CinderWOOD



WALL MOUNTED & FLOOR STANDING SUITES

Our beautiful wall mounted suites are perfect if you are looking to save floor space, or like a sleek minimal look.

And Flamerite Fire's floor standing suites are available in both contemporary and traditional styles and will instantly transform your room, providing an eye-catching focal point.



Luma 1360



Luma 900



LUMA

- White pebble and glass beads (Cinderwood as cost option)
- Choice of Smart eControl featuring Radia Flame 3D or Fire eControl featuring Nitra Flame*
- Thermostatically controlled 1000W/2000W concealed fan heater
- LED flame effect and multi coloured downlights
- Smooth or a textured paint finish available in ivory cream, arctic white or pastel grey
- 3D bowl available 900 & 1200
- Install onto a flat wall
- Floor standing available (see Ador Suite p.15)
- 900 h:610 w:880 d:255
- 1200 h:610 w:1200 d:255
- 1360 h:555 w:1360 d:255



CinderWOOD



*Choice of control not available on Luma Bowl, Smart eControl featuring Radia Flame 3D only.



Jaeger 1020 – features an open fronted fuel bed.



JAEGER

- Cinderwood log effect
- Choice of Smart eControl featuring Radia Flame 3D or Fire eControl featuring Nitra Flame
- Thermostatically controlled 750W/1500W concealed fan heater*
- OmniGlide 2 position front glass with dimmable LED flame effect**
- Smooth or a textured paint finish available in ivory cream, arctic white or pastel grey
- Install onto a flat wall or with semi inset option***
- 1360 h:550 w:1360 d:255
- 1020 h:625 w:1020 d:255



*Jaeger 1020 is 1000W/2000W. **OmniGlide is not available on the Jaeger 1020. ***Only the Jaeger 1360 is semi inset.



Jaeger 1360



ADOR

- White pebble and glass beads (log & embers as cost option)
- Choice of Smart eControl featuring Radia Flame 3D or Fire eControl featuring Nitra Flame
- Thermostatically controlled 1000W/2000W concealed fan heater
- LED flame effect and downlights
- Smooth or a textured paint finish available in ivory cream, arctic white or pastel grey
- Install onto a flat wall
- h:610 w:1200 d:255

Available floor standing



OMNIGLIDE®



LUCA 450

- Cinderwood log effect
- Choice of Smart eControl featuring Radia Flame 3D or Fire eControl featuring Nitra Flame
- Thermostatically controlled 750W/1500W concealed fan heater
- OmniGlide 2 position front glass
- Smooth or a texture paint finish in ivory cream, arctic white or pastel grey
- Install onto a flat wall

White flame effect



OMNIGLIDE®

CinderWOOD





MAGELLAN

- Cinderwood log effect
- Choice of Smart eControl featuring Radia Flame 3D or Fire eControl featuring Nitra Flame
- Thermostatically controlled 750W/1500W concealed fan heater
- OmniGlide 2 position front glass with dimmable LED flame effect
- Smooth or a textured paint finish available in ivory cream (shown), arctic white or pastel grey
- Grey slate inner hearth
- Install onto a flat wall
- h:970 w:1100 d:305



OMNIGLIDE® CINDERWOOD



VIRTUE

- Cinderwood log effect or glowing coals
- Choice of Smart eControl featuring Radia Flame 3D or Fire eControl featuring Nitra Flame
- Thermostatically controlled 750W/1500W concealed fan heater
- OmniGlide 2 position front glass
- Multi-colour ambient lit floating back panel
- Smooth or a texture paint finish in ivory cream, arctic white or pastel grey
- Install onto a flat wall



OMNIGLIDE® CINDERWOOD



Floating panel lit in mint





PRINCETON

- Cinderwood log effect
- Choice of Smart eControl featuring Radia Flame 3D or Fire eControl featuring Nitra Flame
- Thermostatically controlled 750W/1500W concealed fan heater
- OmniGlide 2 position front glass with dimmable LED flame effect
- Frameless with optional silver or brass trim
- Smooth or a textured paint finish available in ivory cream (shown), arctic white or pastel grey
- Install onto a flat wall
- h:1000 w:1140 d:300



OMNIGLIDE® CINDERWOOD



GOTHAM 900

- Cinderwood log effect
- Choice of Smart eControl featuring Radia Flame 3D or Fire eControl featuring Nitra Flame
- Thermostatically controlled 750W/1500W concealed fan heater
- OmniGlide 2 position front glass with dimmable LED flame effect
- Frameless with optional silver or brass trim
- Log store (logs not supplied)
- Smooth or a textured paint finish available in ivory cream, arctic white (shown) or pastel grey
- Install onto a flat wall
- h:1105 w:1220 d:200

Silver frame



OMNIGLIDE® CINDERWOOD





KAYDEN 1300/900

- Cinderwood log effect
- Choice of Smart eControl featuring Radia Flame 3D or Fire eControl featuring Nitra Flame
- Thermostatically controlled 750W/1500W concealed fan heater
- OmniGlide 2 position front glass with dimmable LED flame effect
- Smooth or a textured paint finish available in ivory cream (shown), arctic white or pastel grey
- Install onto a flat wall
- 1300 h:790 w:2000 d:350
- 900 h:790 w:1595 d:350

Kayden 900



OMNIGLIDE® CINDERWOOD



TELISA

- Cinderwood log effect
- Choice of Smart eControl featuring Radia Flame 3D or Fire eControl featuring Nitra Flame
- Thermostatically controlled 750W/1500W concealed fan heater
- OmniGlide 2 position front glass
- Multi-colour ambient lit back panel
- Smooth or a texture paint finish in ivory cream, arctic white or pastel grey
- Install onto a flat wall

Back panel lit in white



OMNIGLIDE® CINDERWOOD





MANHATTAN

- Cinderwood log effect
- Choice of Smart eControl featuring Radia Flame 3D or Fire eControl featuring Nitra Flame
- Thermostatically controlled 750W/1500W concealed fan heater
- OmniGlide 2 position front glass with dimmable LED flame effect
- Frameless with optional silver or brass trim
- Smooth or a textured paint finish available in ivory cream (shown), arctic white or pastel grey
- Install onto a flat wall
- h:1000 w:1140 d:300



OMNIGLIDE® CINDERWOOD



AUSTEN 54

- Log or coal effect
- Smart eControl featuring Radia Flame 3D
- Thermostatically controlled 1000W/2000W concealed fan heater
- Oak finish with a granite effect hearth
- Install onto a flat wall
- h:1160 w:1370 d:390



Tennyson Cast – see p.72





Bronte with Tennyson Cast – see p.72



BRONTE

- Cinderwood log effect*
- Choice of Smart eControl featuring Radia Flame 3D or Fire eControl featuring Nitra Flame
- Thermostatically controlled 750W/1500W concealed fan heater
- OmniGlide 2 position front glass with dimmable LED flame effect

Gotham 750 and Cast available with:

- Smooth or a textured paint finish available in ivory cream (shown), arctic white or pastel grey
- Install onto a flat wall
- 54" h:1170 w:1370 d:390
- 48" h:1110 w:1220 d:375**



*Cinderwood log effect is not available with Tennyson Cast – see page 72. **Bronte with Gotham 750 is not available in 48".



Bronte with Gotham 750



MERCIA / VALENTINO

MERCIA



- White pebbles or glass beads as standard with log & embers as cost option
- Choice of Smart eControl featuring Radia Flame 3D or Fire eControl featuring Nitra Flame
- Thermostatically controlled 1000W/2000W concealed fan heater
- Dimmable LED flame effect
- Smooth or a textured paint finish available in ivory cream (shown), arctic white or pastel grey
- Install onto a flat wall
- h:890 w:1050 d:380



VALENTINO



- White pebbles or glass beads as standard with log & embers as cost option
- Choice of Smart eControl featuring Radia Flame 3D or Fire eControl featuring Nitra Flame
- Thermostatically controlled 1000W/2000W concealed fan heater
- Dimmable LED flame effect and multi coloured internal downlights
- Smooth or a textured paint finish available in ivory cream, arctic white (shown) or pastel grey
- Install onto a flat wall
- h:980 w:1170 d:360



AUBADE WITH TENNYSON CAST

- Log or coal fuel effect
- Smart eControl featuring Radia Flame 3D
- Thermostatically controlled 1000W/2000W concealed fan heater
- h:1135 w:1220 d:390
- Smooth or a textured paint finish available in ivory cream, arctic white or pastel grey (shown) with a granite effect hearth
- Install onto a flat wall



AUBADE WITH OMNIGLIDE 600

- Cinderwood log effect
- Choice of Smart eControl featuring Radia Flame 3D or Fire eControl featuring Nitra Flame
- Thermostatically controlled 750W/1500W concealed fan heater
- OmniGlide 2 position front glass with dimmable LED flame effect
- Frameless with optional silver or brass trim
- h:1135 w:1220 d:390
- Smooth or a textured paint finish available in ivory cream, arctic white or pastel grey (shown) with a granite effect hearth
- Install onto a flat wall



OMNIGLIDE® CINDERWOOD



HEARTH INSET FIRES & CAST

If you already have a fireplace, or space you want to put a new fire into, then our range of hearth inset fires are for you.

Designs range from the totally traditional to the modern and will fit standard hearth openings. You can even opt for a stove if it suits your surroundings best (Luca 450 p25). With a choice of fuel bed, finish and trim options you can tailor your fire to suit the style of your room.



ENNIO 3

- Cinderwood log effect or glowing coals
- Choice of Smart eControl featuring Radia Flame 3D, Fire eControl featuring Nitra Flame or manual control
- Glass front (OmniGlide with remote and app controls)
- Thermostatically controlled 750W/1500W concealed fan heater
- Fire trim options: silver, gun metal or brass
- Flat wall spacer available
- Hearth fire inset from 130mm
- Also available as a 4 sided hole in the wall inset on p.38



OMNIGLIDE® CinderWOOD





RAYLIA

- Cinderwood log effect
- Choice of Smart eControl featuring Radia Flame 3D, Fire eControl featuring Nitra Flame or manual control
- Glass front (OmniGlide with remote and app controls)
- Thermostatically controlled 750W/1500W concealed fan heater
- Fire trim options: silver or brass
- Flat wall spacer available
- Hearth fire inset from 130mm



Brass trim



SOLACE

- Cinderwood log effect or glowing coals
- Choice of Smart eControl featuring Radia Flame 3D, Fire eControl featuring Nitra Flame or manual control
- Glass front (OmniGlide with remote and app controls)
- Thermostatically controlled 750W/1500W concealed fan heater
- Fire trim options: black mirror or graphite
- Flat wall spacer available
- Hearth fire inset from 130mm



Glowing coals with graphite trim



MARINER

- Manual control with Radia Flame 3D burn
- Concealed 1000W/2000W thermostatically controlled fan heater
- Hearth fire with 75mm inset
- Choice of fuel effects: coal, pebbles or logs & embers as cost option
- Silver only finish
- Flat wall spacer available



ARLO 22

- Log and embers
- Choice of Smart eControl featuring Radia Flame 3D, Fire eControl featuring Nitra Flame or manual control
- Concealed 750W/1500W thermostatically controlled heater
- Fire trim options: silver, gun metal or brass
- Designed to fit into a standard opening 16.5" x 22.5" / 42cm x 57cm
- Hearth fire with 75mm inset
- Flat wall spacer available



Gun metal trim

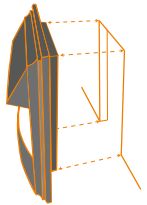

Designed to be inset into a standard opening
16.5" x 22.5" / 42cm x 57cm





ATLANTA 3

- Cinderwood log effect
- Choice of Smart eControl featuring Radia Flame 3D or Fire eControl featuring Nitra Flame
- Thermostatically controlled 750W/1500W concealed fan heater
- OmniGlide 2 position front glass with dimmable LED flame effect
- Fire trim options: graphite, silver or brass
- Hearth depth 185mm



OMNIGLIDE® CINDERWOOD



HUDSON

- Manual or remote control with Radia Flame 3D
- Concealed 1000W/2000W thermostatically controlled fan heater
- Hearth fire with 75mm inset
- Choice of fuel effects: coals, white pebbles or glass beads as standard with twigs & embers as cost option
- Fret choice: Blenheim (left) Bauhaus (right)
- Choice of colour finish: gun metal or silver
- Flat wall spacer available



CISCO 16

- Manual or remote control with Radia Flame 3D
- Concealed 1000W/2000W thermostatically controlled fan heater
- Hearth fire with 50mm inset
- Choice of fuel effects: coals, white pebbles or glass beads as standard with logs & embers as cost option
- Choice of colour finish: silver, brass or black
- Flat wall spacer available



CISCO 16 EXTREME

What makes it Extreme?

The Cisco Extreme comes with all the features and options of the Cisco, but also has a highlighted back lit fret.



CISCO 22

- Manual or remote control with Radia Flame 3D
- Concealed 1000W/2000W thermostatically controlled fan heater
- Choice of fuel effects: coals, white pebbles or glass beads as standard with logs & embers as cost option
- Choice of colour finish: silver, brass or black
- Designed to be inset into a standard opening 16.5" x 22.5" / 42cm x 57cm with 40mm inset
- Flat wall spacer available

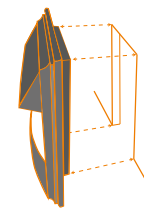

Designed to be inset
into a standard opening
16.5" x 22.5" / 42cm x 57cm



CISCO 22 EXTREME

What makes it Extreme?

The Cisco 22 Extreme comes with all the features and options of the Cisco 22, but also has a highlighted back lit fret.

TYRUS 16

- Manual or remote control with Radia Flame 3D
- Concealed 1000W/2000W thermostatically controlled fan heater
- Hearth fire with 40mm inset
- Choice of fuel effects: coals, white pebbles or glass beads as standard with twigs & embers as cost option
- Choice of colour finish: silver or brass
- Flat wall spacer available

RADIA *Flame* 3D

essence
DESIGN LTD



TYRUS 22

- Manual or remote control with Radia Flame 3D
- Concealed 1000W/2000W thermostatically controlled fan heater
- Choice of fuel effects: coals, white pebbles or glass beads as standard with logs & embers as cost option
- Choice of colour finish: silver, black or brass
- Designed to be inset into a standard opening 16.5" x 22.5" / 42cm x 57cm with 40mm inset
- Flat wall spacer available

RADIA *Flame* 3D

essence
DESIGN LTD

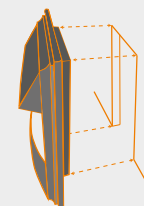

Designed to be inset
into a standard opening
16.5" x 22.5" / 42cm x 57cm





REGAN 16

- Manual or remote control with Radia Flame 3D
- Concealed 1000W/2000W thermostatically controlled fan heater
- Hearth fire with 40mm inset
- Choice of fuel effects: coals, white pebbles or glass beads as standard with twigs & embers as cost option
- Choice of colour finish: silver or brass
- Flat wall spacer available

RADIA Flame

essence



Brass



REGAN 22

- Manual or remote control with Radia Flame 3D
- Concealed 1000W/2000W thermostatically controlled fan heater
- Choice of fuel effects: coals, white pebbles or glass beads as standard with logs & embers as cost option
- Choice of colour finish: silver, black or brass
- Designed to be inset into a standard opening 16.5" x 22.5" / 42cm x 57cm with 40mm inset
- Flat wall spacer available

RADIA Flame

essence



Brass

TENNYSON CAST

- Smart eControl featuring Radia Flame 3D
- Cast can be sold separately or used in the following surrounds: Austen, Aubade, Bronte & Corbel
- Log or coal fuel effect
- Thermostatically controlled 1000W/2000W concealed fan heater
- h:950 w:950 d:250



FLAMERITE FIRES 2020-21

VIEW OUR FULL RANGE OF FLAMERITE FIRES

www.flameritefires.com

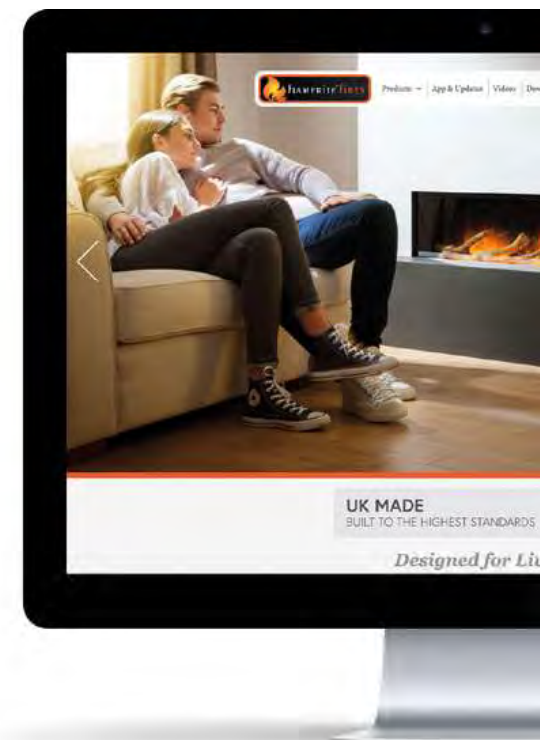

GOTHAM FIRES

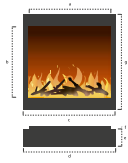

Page	Name	a	b	c	d	e	f	g
32	Gotham 750S	754	405	850	605	160	20	630
32	Gotham 750T	754	650	850	755	160	20	875
33	Gotham 600	604	500	700	605	160	20	730

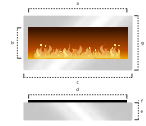

Page	Name	a	b	c	d	e	f	g
34	Gotham 1300	1304	280	1400	1305	160	20	500
35	Gotham 900	904	280	1000	905	160	20	500

WALL MOUNTED FIRES

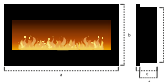

Page	Name	a	b	c	d	e	f
36	Verada	825/1000	640	185	160	520	560
37	OmniSlide® 900	1050	560	190	160	920	505
38	Ennio 4 Side	500	605	190	160	405	560

WALL MOUNTED SUITES

Add 150mm to size b if using 'door' standing suite



Page	Name	a	b	c
40	Luma 1200	1200	610	255
40	Luma 1360	1360	555	255
40	Luma 900	880	610	255
44	Ador	1200	610	255

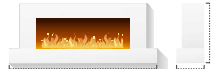

Page	Name	a	b	c
42	Jaeger 1020	1020	625	255
42	Jaeger 1360	1360	550	255

FLOOR STANDING SUITES

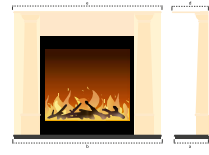

Page	Name	a	b	c	d	e
44	Ador	255	1200	760	205	1000
45	Luca 450	375	1220	1010	245	1140
46	Magellan	305	1100	970	305	1100
47	Virtue	245	1220	985	245	1140
48	Princeton	300	1140	1000	260	1140
49	Gotham 900 Suite			1105	200	1220
50	Kayden 1300 Suite	350	2000	790	240	1915
50	Kayden 900 Suite	350	1595	790	240	1515
51	Telsa	350	1323	883	250	350
52	Manhattan	300	1140	1000	260	1140
53	Austen 54"	390	1370	1160	280	1350
54	Bronte 54" with Tennyson Cast	390	1370	1170	335	1370
54	Bronte 48" with Tennyson Cast	375	1220	1110	300	1220
54	Bronte 54" with Gotham 750	390	1370	1170	335	1370
56	Mercia	380	1050	890	240	1060
56	Valentino	360	1170	980	280	1170
57	Aubade 48" with OmniSlide® 600	390	1220	1135	260	1220
57	Aubade 48" with Tennyson Cast	390	1220	1195	260	1220

HEARTH INSET FIRES



Page	Name	a	b	c	d	e	f
59	Ennio 3 Side	500	600	190	160	405	560
60	Raylla	495	595	230	160	405	560
61	Solace	495	595	190	160	405	560
62	Mariner	505	610	210	75	385	550
65	Hudson	505	610	210	75	385	550
66	Cisco 16	480	600	180	50	385	550
66	Cisco 16 Extreme	480	600	180	50	385	550
68	Tyrus 16	485	600	200	40	385	550
70	Regan 16	485	600	200	40	385	550

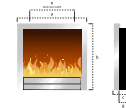

Page	Name	a	b	c	d	e	f
63	Ario 22	640	610	135	80	410	560
64	Atlanta 3	660	580	185	160	530	565
67	Cisco 22	660	600	170	40	405	550
67	Cisco 22 Extreme	660	600	170	40	405	550
69	Tyrus 22	660	600	170	40	405	550
71	Regan 22	660	600	170	40	405	550

CAST FIRES

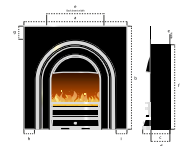

Page	Name	a	b	c	d	e	f	g	h	i	j
72	Tennyson	950	950	250	175	530	780	125	100	100	

COLOUR GUIDE

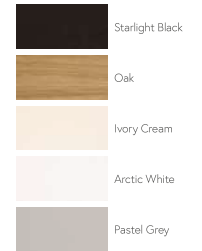

NOTE: Due to the limitations of the four colour printing process, the following colours are to be used as a guide only.